

UDHAYONMUKH

THE BLOOMING SPACES OF HAMPI

LOCATION

CONTEXT

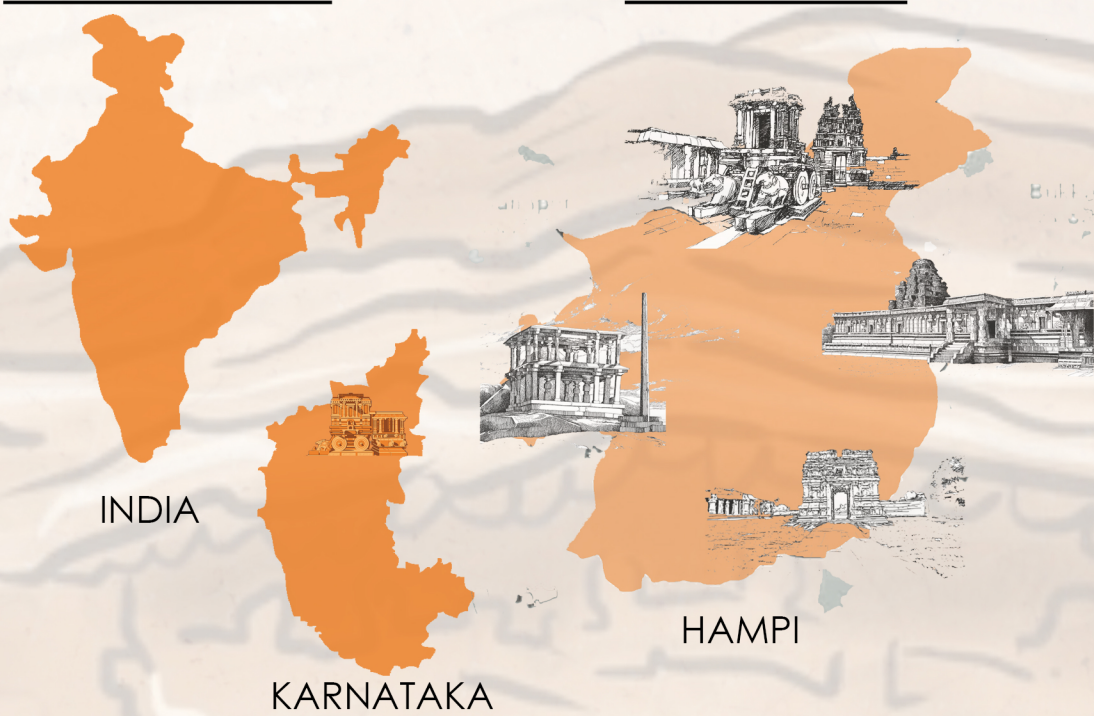

In this design we are modifying the existing spaces and utilizing it such that the functionality aspect increases.

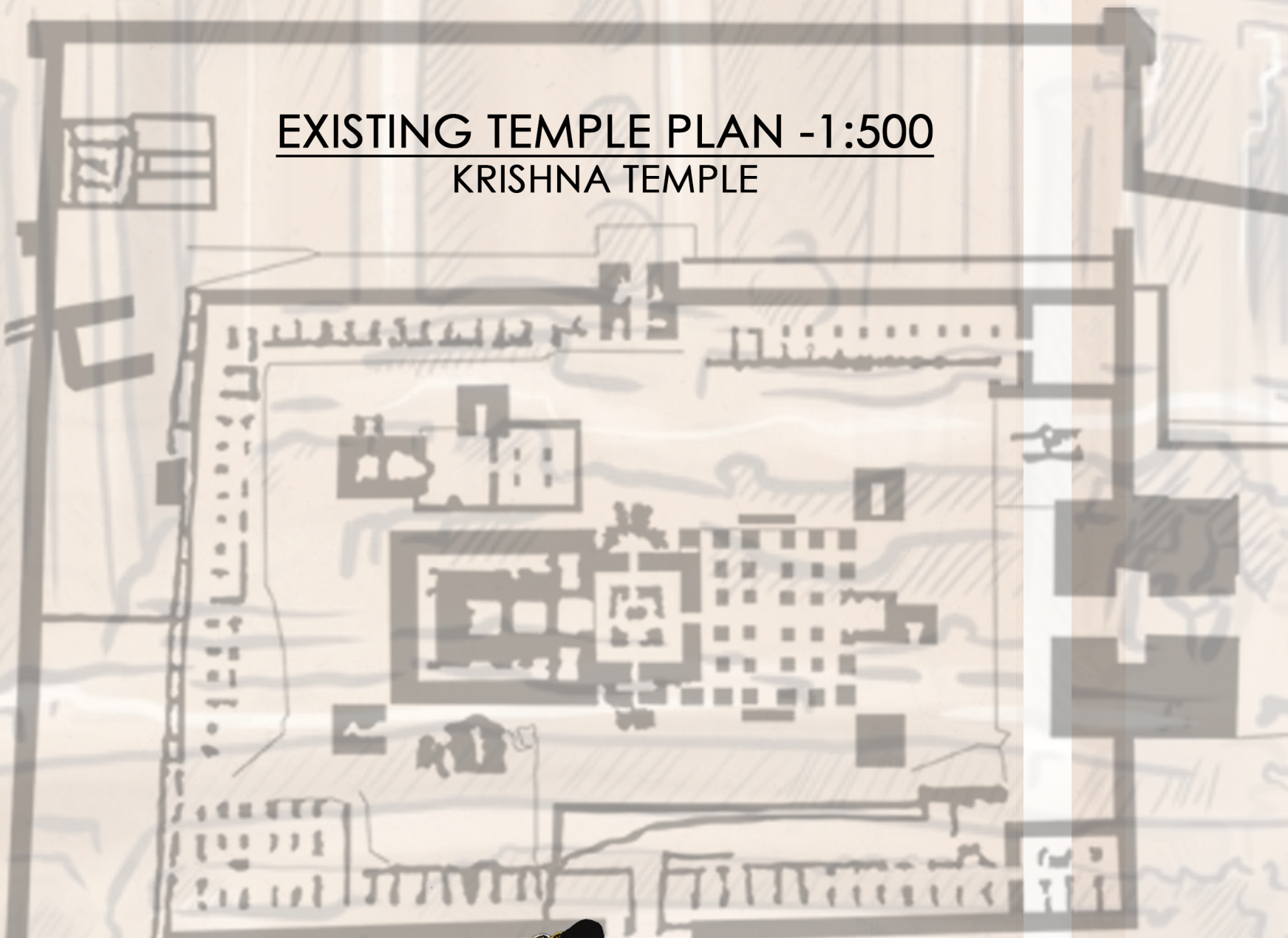

EXISTING TEMPLE PLAN -1:500
KRISHNA TEMPLE

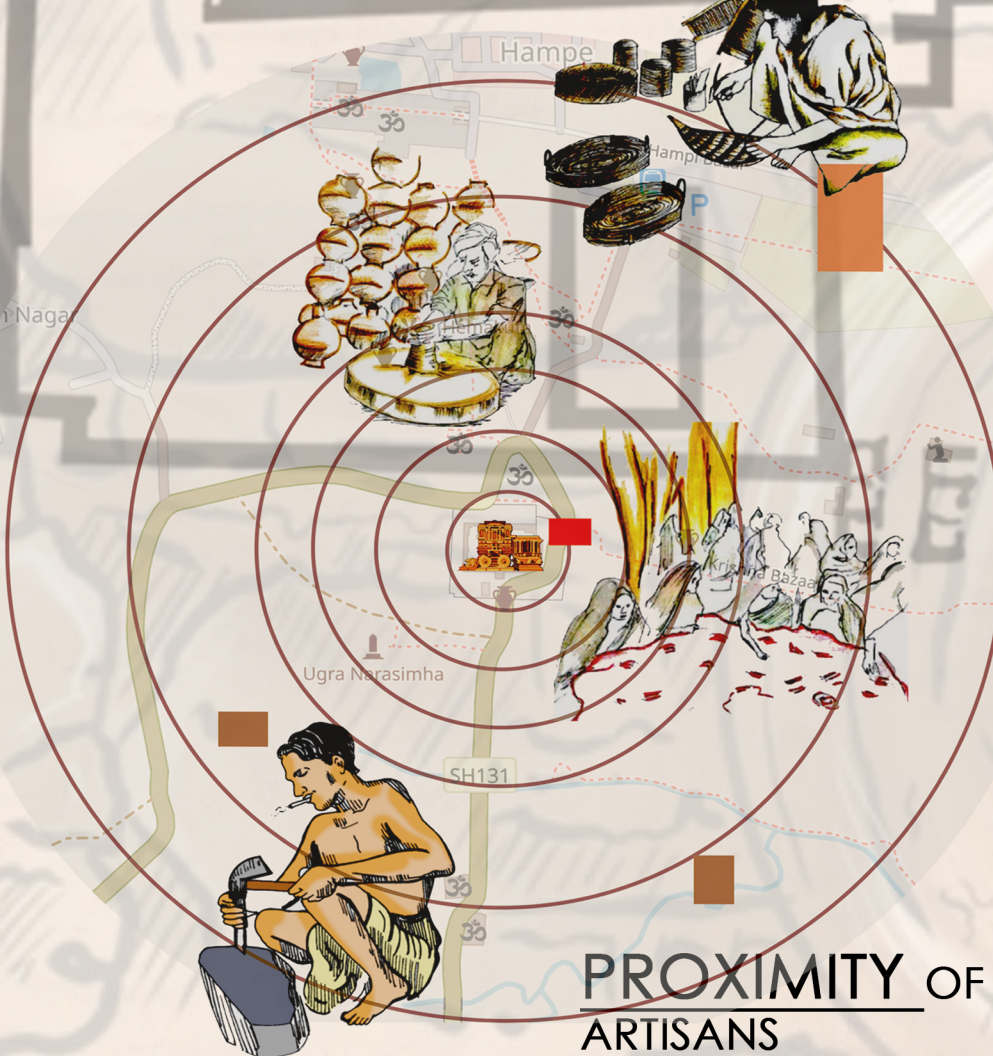

SECTION OF THE TEMPLE COMPLEX - 1:500

Hampi is an ancient historic site which was built by Krishnadevaraya, in the sixteenth century for his victory over orissa. The city of victory is in ruins where tourists around the globe visit. This city is an UNESCO world heritage site.

Our design endeavors to utilize the spaces of the ruined Sri Krishna Swami Temple Complex which was the first religious monument constructed in the city. The intervention is to make use of the Old Bazaar street(chariot street) and spaces in and around the kalyani.



@A - VIEW OF THE KALYANI/KUND

he actual purpose of the kalyani is to store water and use it for sacred purpose, but as the temple is not in use the kalyani is dry and only gets stored up with water when there is rain, so during the dry months the kund acts as a place of cultural gathering where



@B - VIEW OF THE PATHWAY

View of the pathway leading to the bazaar and kalyani: has a series of installations which depicts some of the epic scenes that have been developed in hampi, these include scenes from Pampakshetra, Ramayana, and the war victory from the Mauryan and the Orissa kingdom.

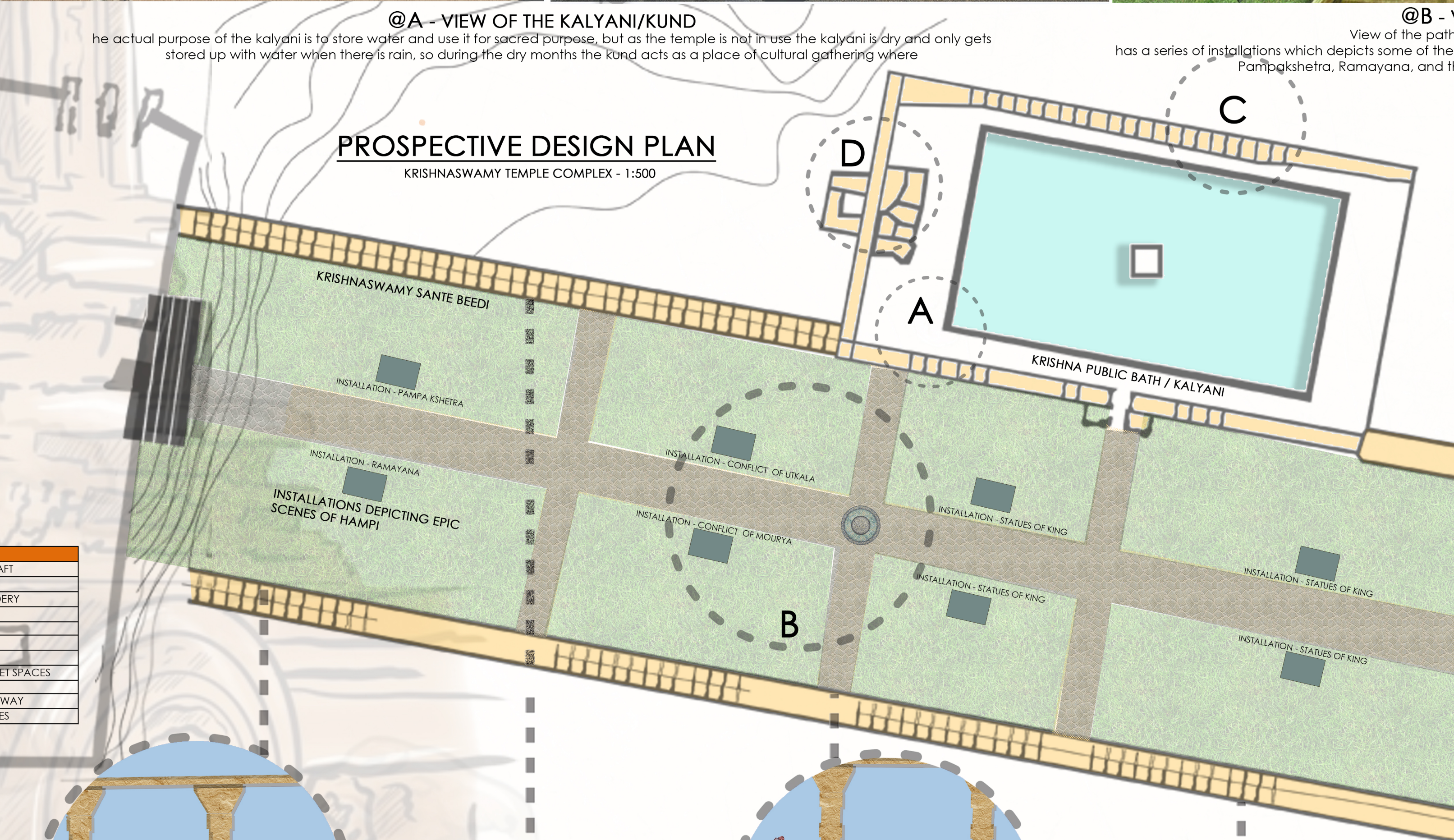

PROSPECTIVE DESIGN PLAN
KRISHNASWAMY TEMPLE COMPLEX - 1:500

| FUNCTION | CATEGORY | SUB CATEGORY |
|----------|----------------------|-------------------------|
| BAZAAR | CRAFT MAKING SPACE | BANANA FIBER CRAFT |
| | | CANE FIBRE CRAFT |
| | | LAMBANI EMBROIDERY |
| | CRAFT SELLING SPACES | STONE CARVING |
| | | POTTERY |
| | | TEMPORARY MARKET SPACES |
| | ANCILLARY SPACES | EXPERIENCE WALK WAY |
| | | CULTURAL ACTIVITIES |



VEGETABLE BAZAAR



COCONUT STALLS



TEA/COFFEE STALLS



FLOWER BAZAAR

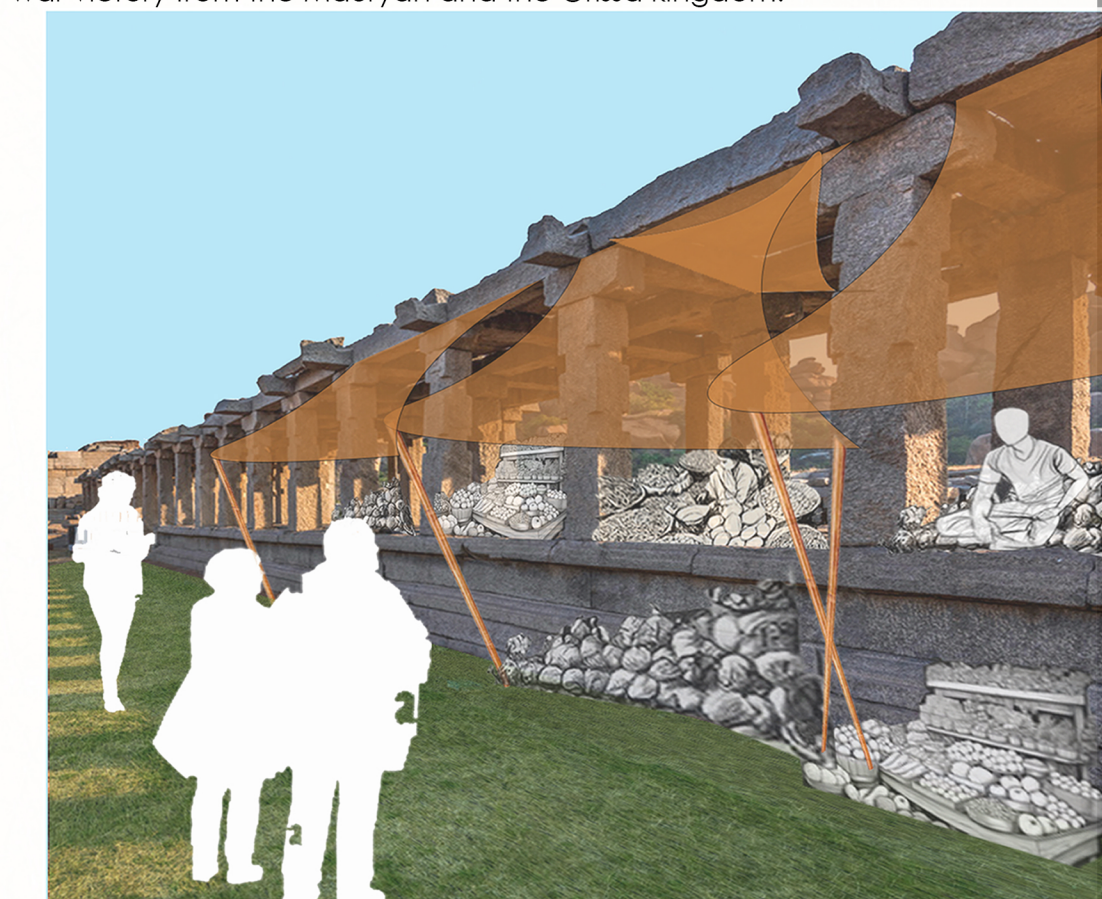

@C - VIEW OF THE MARKET SPACES

to have markets where people around the site can access it to buy fruits, vegetables, etc.. It acts like a transitional space between the temple and kund. Allows social economical gathering

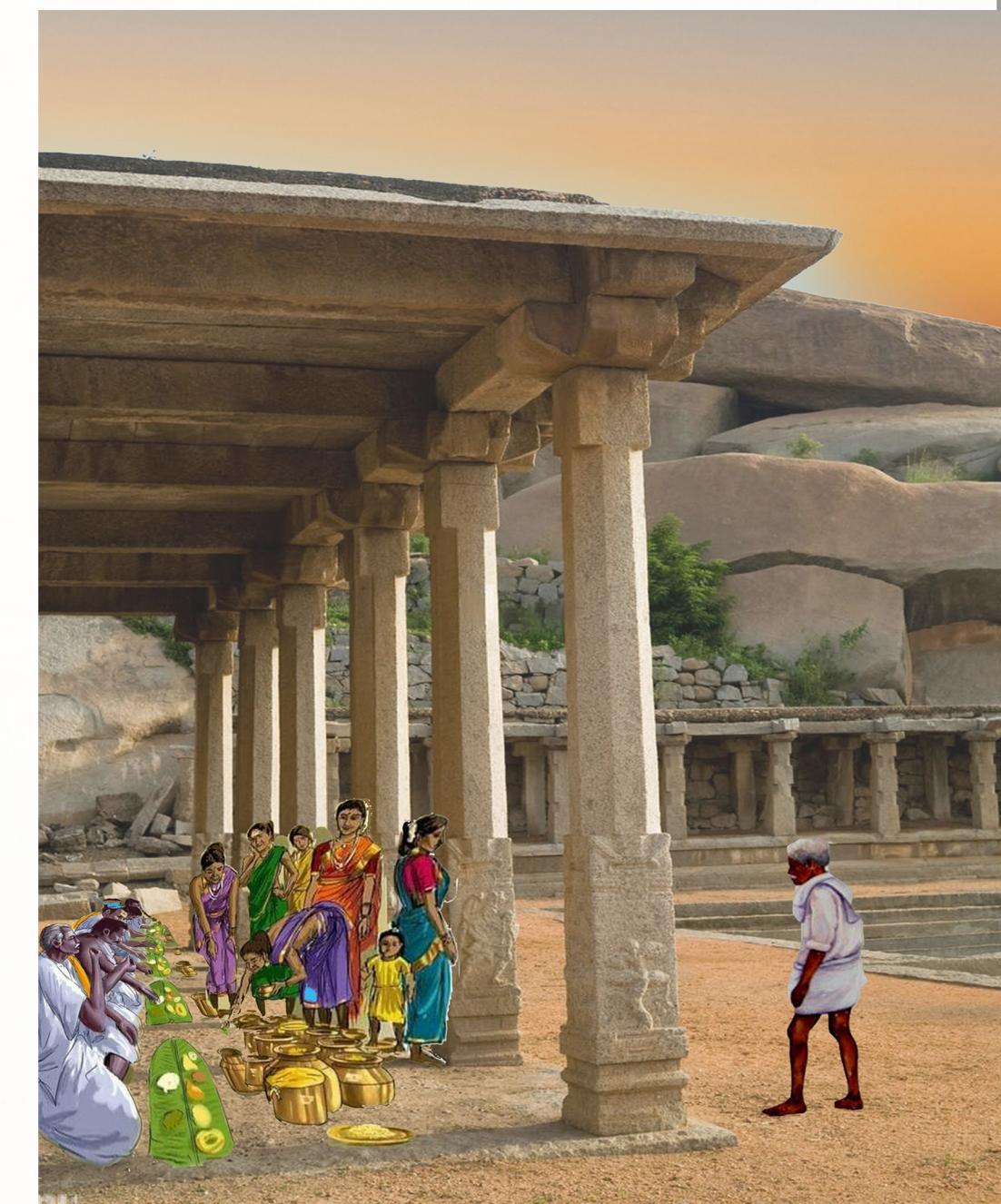

@D - VIEW OF THE PILLARED HALLS

to have markets where people around the site can access it to buy fruits, vegetables, etc.. It acts like a transitional space between the temple and kund. Allows social economical gathering

SECTION OF THE MARKET SPACE - 1:500